

Installation Instructions

PM - Projector Mount System

Design Highlights

- Beautiful Anodised Aluminium Finish
- Complete Lead-Screw Adjustment of All Pitches of Angle
- Range of Fixed and Telescopic Poles Available
- Range of Mount Plates for Neatest Possible Mounting
- Hook on, Hook off Installation

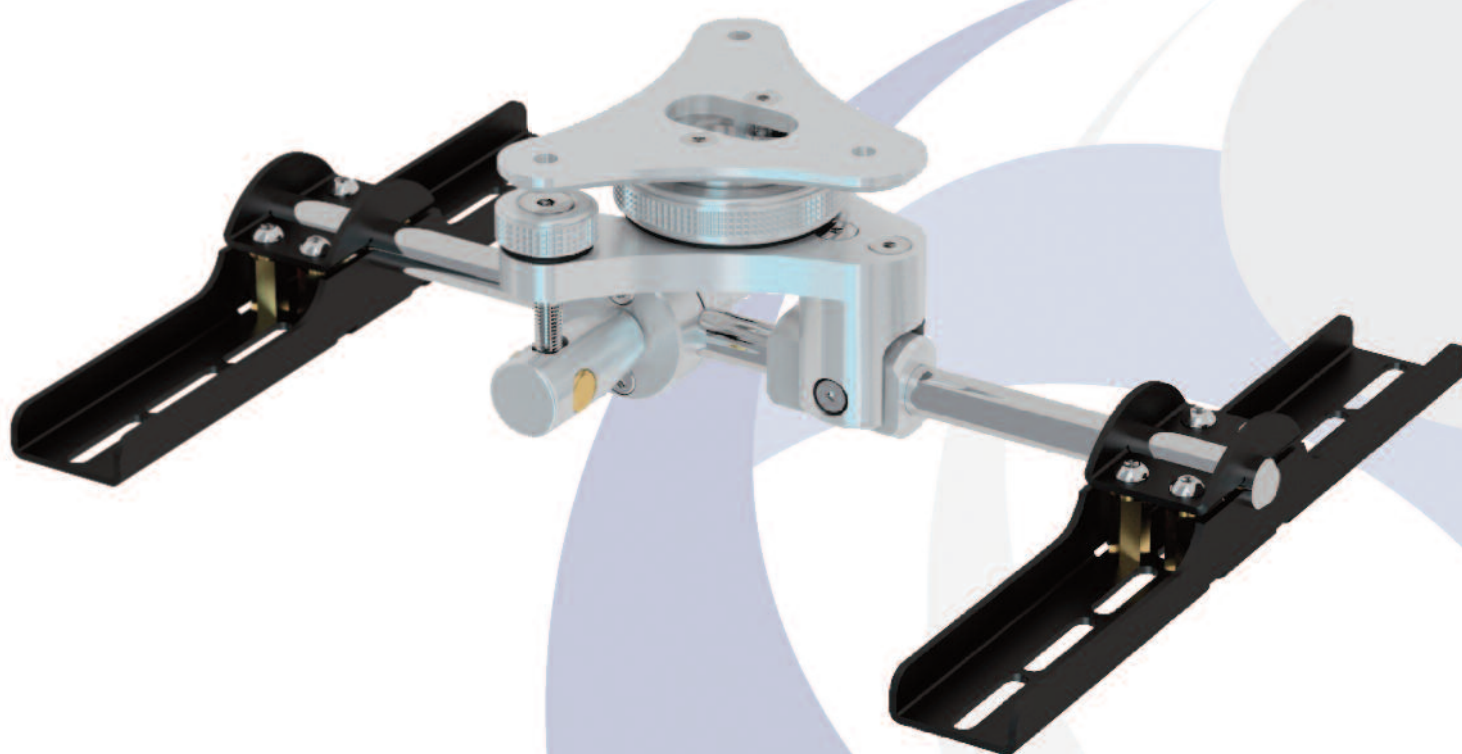

Thank you for choosing
futureautomation

PM - Projector Mount System



Caution
Warning



Beware of
Moving Parts



Danger
Electricity



Keep Hands
Clear

Safety Disclaimer

Important Safety Instructions

Explanation of graphical symbols

-(Electric Shock Symbol) = The lightning flash within an equilateral triangle is intended to alert you to the presence of un-insulated "dangerous voltage" within the products enclosure that may be of sufficient magnitude to constitute an electric shock to persons

-(Caution Symbol) = The exclamation point within an equilateral triangle is intended to alert you to the presence of important operating and maintenance (servicing) instructions in the literature accompanying the product

-(Tools Symbols) = The tools symbol within a coloured square are intended to highlight the required tools necessary for correct and safe installation of the product. These are intended as a guide only, and it is at the installer's discretion as to which tools are used.

WARNING: RISK OF ELECTRIC SHOCK, ONLY AUTHORIZED INSTALLERS TO OPEN THE POWER CONTROL BOX.

WARNING: To reduce the risk of fire or electric shock, do not expose electrical parts to rain or moisture, unless the product has been specifically designed to do so.

WARNING: Failure to provide adequate structural strengthening, prior to installation can result in serious personal injury or damage to the equipment. It is the installer's responsibility to ensure the structure to which the component is affixed can support the four times the weight of the component.

WARNING: Do not exceed the weight capacity. This can result in serious personal injury or damage to the equipment. It is the installer's responsibility to ensure that the total combined weight of all attached components does not exceed that of the maximum figure stated.

WARNING: Failure to provide adequate structural strength for this component can result in serious personal injury or damage to equipment! It is the installer's responsibility to make sure the structure to which this component is attached can support five times the combined weight of all equipment. Reinforce the structure as required before installing the component.

Warnings:

1. Read all technical instructions fully before installation and use. It is the installer's responsibility to ensure that all documentation is passed on the end user and read fully before operation.
2. Keep all documentation.
3. Heed all warnings.
4. Follow all technical specifications and instructions during installation.
5. Do not use near water unless the product has been specifically designed to do so.
6. Clean only with a dry cloth.
7. Do not defeat the purpose of the polarized or grounding type plug. A polarized plug has two blades, one wider than the other. A grounding type plug has two blades and a grounding prong. The wide blade or third prong are provided for your safety. If the provided plug does not fit your outlet, consult an electrician or contact the manufacturer.
8. Protect the power cord from being walked on or pinched, particularly at plugs, convenience receptacles, and the point where the exit from the apparatus.
9. Unplug the apparatus during lightning storms or when unused for long periods of time.
10. Only use attachments/accessories specified by the manufacturer.
11. Refer all servicing to qualified personnel. Servicing is required regularly on an annual basis, when the apparatus is damaged in any way, liquid has been spilled or objects have fallen into the apparatus, the apparatus has been exposed to rain or moisture, does not operate normally, or has been dropped.
12. To completely disconnect the apparatus from the AC mains, disconnect the power cord plug from the AC receptacle on the power control box.
13. To prevent overheating, do not cover the apparatus. Install in accordance with the instructions.
14. UK, Ireland and Hong Kong only – The power cord is supplied with a 13A plug having an earthing pin. The apparatus is earthed and this pin is not required for safety, merely to operate the safety shutter of mains outlet.
15. No naked flames such as lit candles should be placed on the unit.
16. Observe and follow the local regulations when disposing of batteries.
17. Do not expose the unit to dripping or splashing fluids.
18. Do not place objects filled with liquid, such as vases, on the unit.
19. Do not expose the batteries to excessive heat such as sunshine, fire or the like.
20. For all mounted apparatus, the apparatus should be installed on solid wood, bricks, concrete or solid wood columns and battens.
21. Always turn off power at source before putting on or taking off parts and cleaning.
22. Do not use outdoors unless marked for outdoor use.
23. Exceeding the weight capacity can result in serious personal injury or damage to equipment.

Future Sound & Vision trading as Future Automation intend to make this and all documentation as accurate as possible. However, Future Automation makes no claim that the information contained herein covers all details, conditions or variations, nor does it provide for every possible contingency in connection with the installation or use of this product. The information contained in this document is subject to change without prior notice or obligation of any kind. Future Automation makes no representation of warranty, expressed or implied, regarding the information contained herein. Future Automation assumes no responsibility for accuracy, completeness or sufficiency of the information contained in this document.

PM - Projector Mount System

Contents	Page
Introduction	
Safety Information	1
Contents	2
Contents	3
Tool Indicator Icons	3
Installation	
Parts List	
Package Contents	4
Stage 1	
Assembly Construction	5
Stage 2	
Flush Mount	6
Pole Mount	7
Telescopic Pole Mount	8
Wall Mount	9
Stage 3	
Mounting the Projector	10
Stage 4	
Connecting The PM System To The Locking Collar	11
Stage 5	
Projector Adjustment	12
Technical Overview	13

PM - Projector Mount System

Tool Indicator Icons

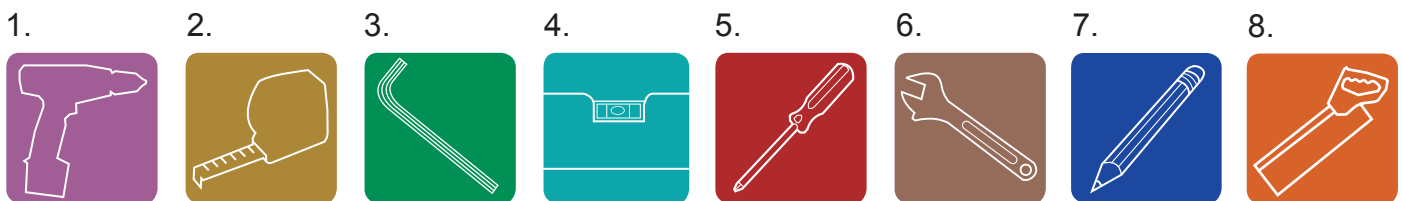

- | | | | |
|-------------------|-------------------|-------------------|-------------|
| 1. - Drill | 3. - Allen Keys | 5. - Screwdrivers | 7. - Pencil |
| 2. - Tape measure | 4. - Spirit Level | 6. - Spanners | 8. - Saw |

Product Warranty

This product carries a warranty that covers the cost of labour and spare parts incurred by any defects in materials and workmanship under normal use during a two year period from date of purchase. Support for any problems that are not hardware faults are excluded from the warranty entitlement. This warranty does not affect your statutory consumer rights.

The following is excluded from warranty service:

- Malfunctioning caused by misuse or damage, accidental or otherwise, or service modification by persons not authorised by Future Automation, or the use of any non Future Automation supplied parts;
- Any electrical, or other environmental work external to your Future Automation mechanism including power cuts, surges or lightning strikes;
- Additional items not supplied by Future Automation although they may have been supplied together by the retailer;
- Any 3rd party software products controlling your mechanism;
- Any transfer of ownership. Warranty is provided only to the initial purchaser;
- Compensation for loss of use of the product, and consequential loss of any kind;
- Use of the product over the specified weight capacity;
- Any damage to products during transit that is not checked and notified as "unchecked" or "damaged" upon receipt of delivery.

Any part of your system that needs to be replaced during a warranty repair becomes the property of Future Automation.



PM - Projector Mount System

PM Package Contents

You should receive your product in 3 separate packs.

Pack 1

Main Body & Front and Rear Bar Clamps
& Standard Projector Mount Kit

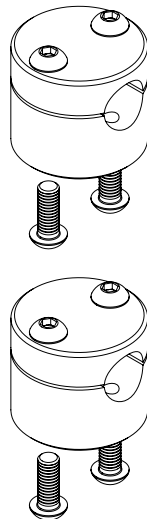
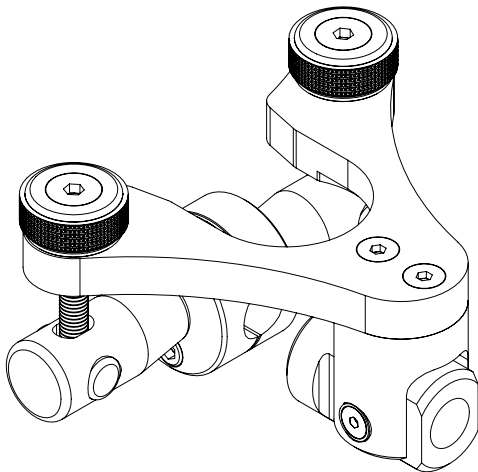

Pack 2

Cross Bar &
Cross Plates

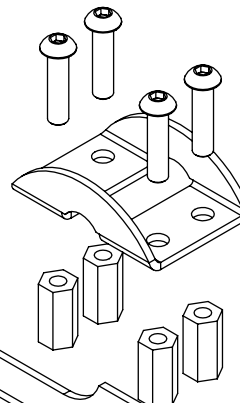

Pack 3

Mount Type Pole or
Flush to Ceiling

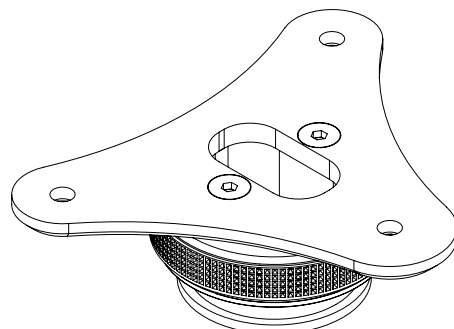
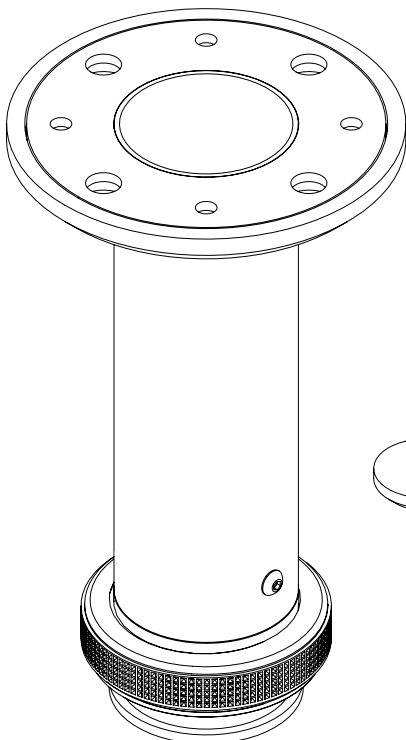

Nuts & Bolts Multipack:

- Qty. 8 - 15OD x 6ID x 3mm Plastic spacer
- Qty. 4 - M4 x 20mm Button head bolt
- Qty. 4 - M4 x 30mm Button head bolt
- Qty. 4 - M5 x 20mm Button head bolt
- Qty. 4 - M5 x 30mm Button head bolt
- Qty. 4 - M6 x 20mm Button head bolt
- Qty. 4 - M6 x 30mm Button head bolt

PM - Projector Mount System



Assembly Construction

Construct the PM System as shown below. Slide the projector bar through the main body and then fix the front and rear bar clamps to each end of the bar. Position the cross plates to match the mounting pattern on the projector being used.

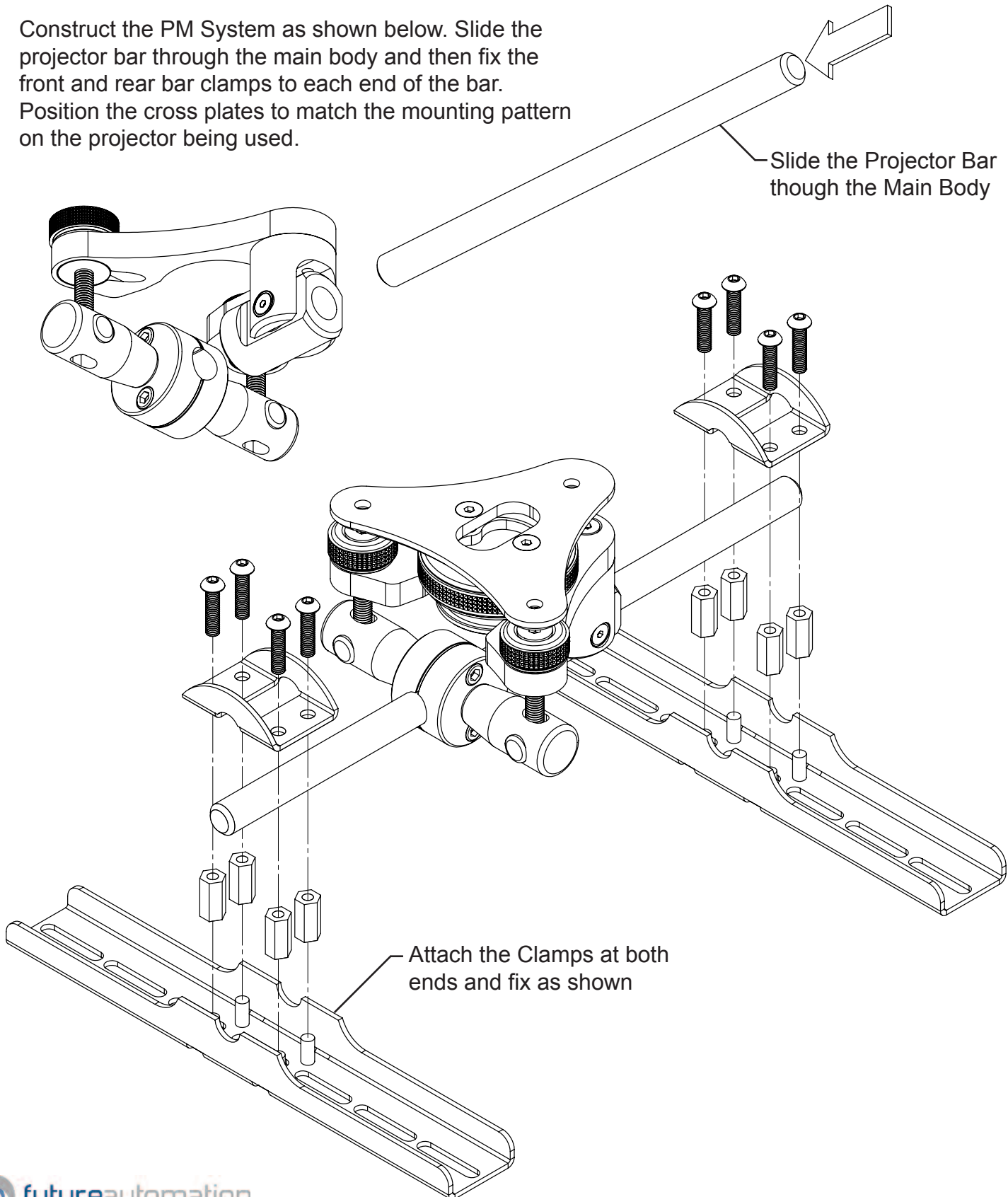

PM - Projector Mount System



Flush Mount

Flat ceiling option - Projector top sits 100mm from the ceiling with 360 degrees rotation.

Mark around fixing holes using a pencil with mount on the ceiling in the desired location. Make sure that the mount will be the correct distance from the projector screen.

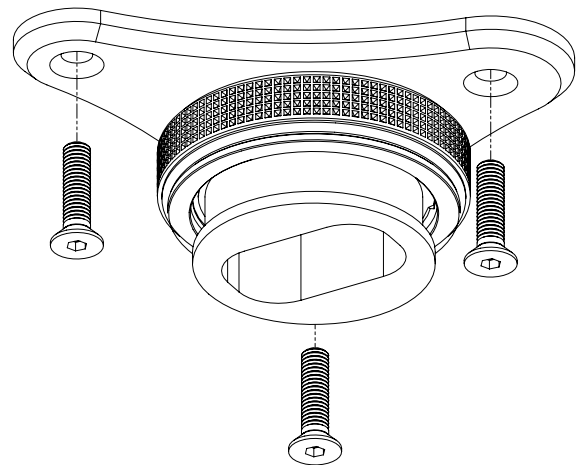
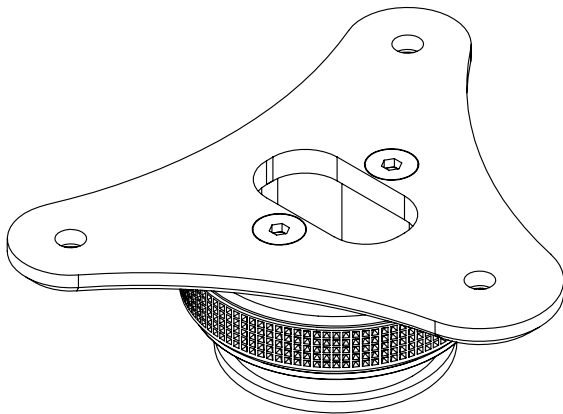

It is the installers responsibility to make sure the mechanism is installed safely and securely

Important Mounting Dimensions (Note - Drawings are not to Scale)

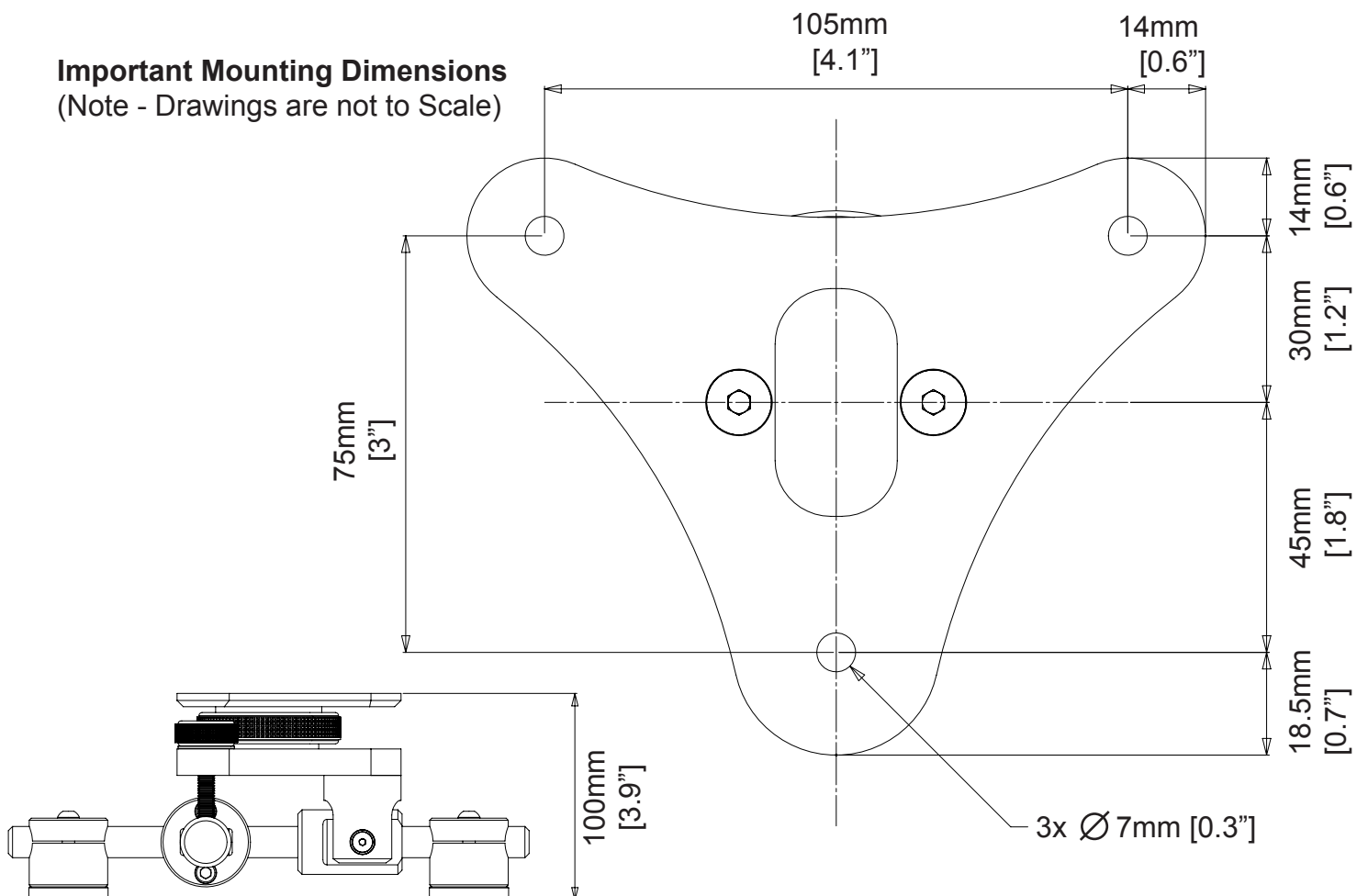

PM - Projector Mount System



Pole Mount

Pole option - Projector top sits 250mm [9.8"], 500 [19.7"] and 750mm [29.5"] away from the ceiling, bespoke sizes can be manufactured. With 360 degrees rotation available.

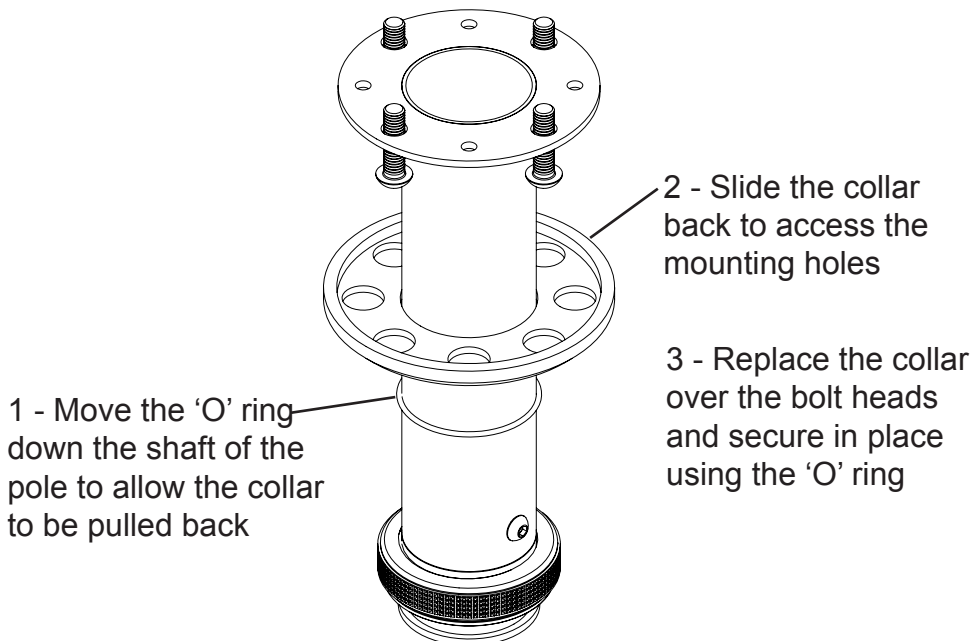

It is the installers responsibility to make sure the mechanism is installed safely and securely



Important Mounting Dimensions (Note - Drawings are not to Scale)

* Heights
250 [9.8], 500 [19.7], 750mm [29.5"] & Bespoke

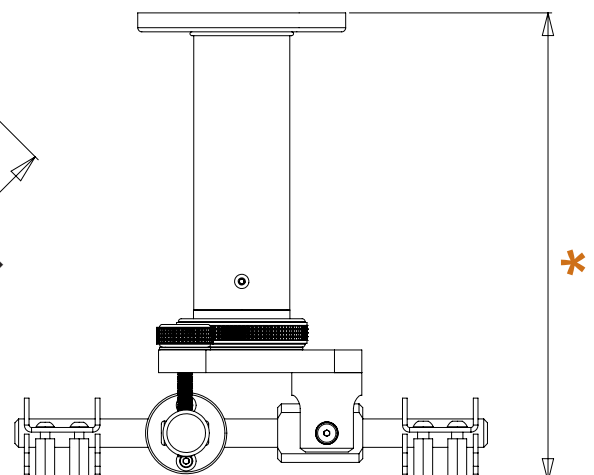
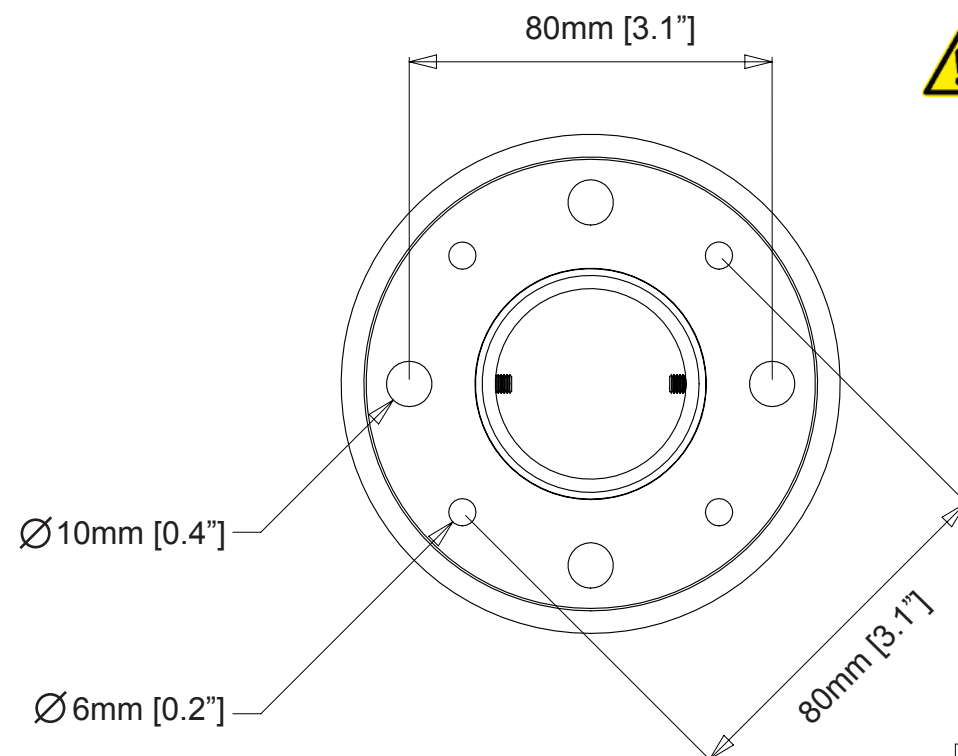

PM - Projector Mount System



Telescopic Pole Mount

Telescopic pole option - Projector top sits 400 [15.7] to 700mm [27.6"] and 700 [27.6] to 1300mm [51.2"] away from the ceiling, bespoke sizes can be manufactured as well. 360 degrees rotation available.
Telescopic Poles are available in 2 standard options:
-400T - 400 [15.7] to 700mm [27.6"]
-700T - 700 [27.6] to 1300mm [51.2"]

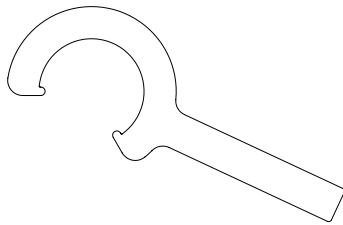

Custom spanner for tightening the locking collar on the pole.



It is the installers responsibility to make sure the mechanism is installed safely and securely.

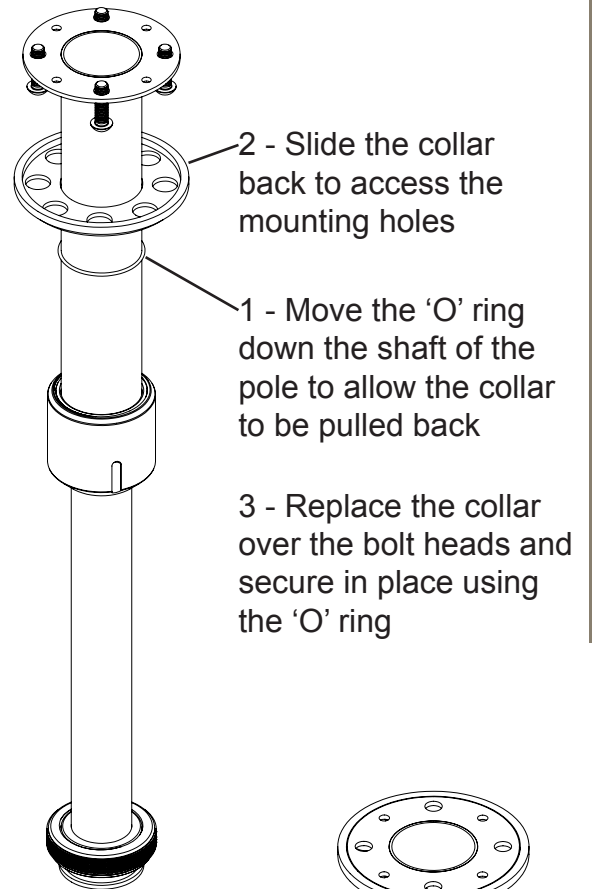

Installation: Stage 2



Important Mounting Dimensions (Note - Drawings are not to Scale)

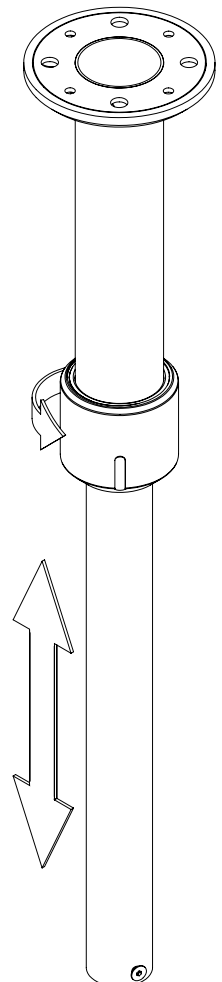
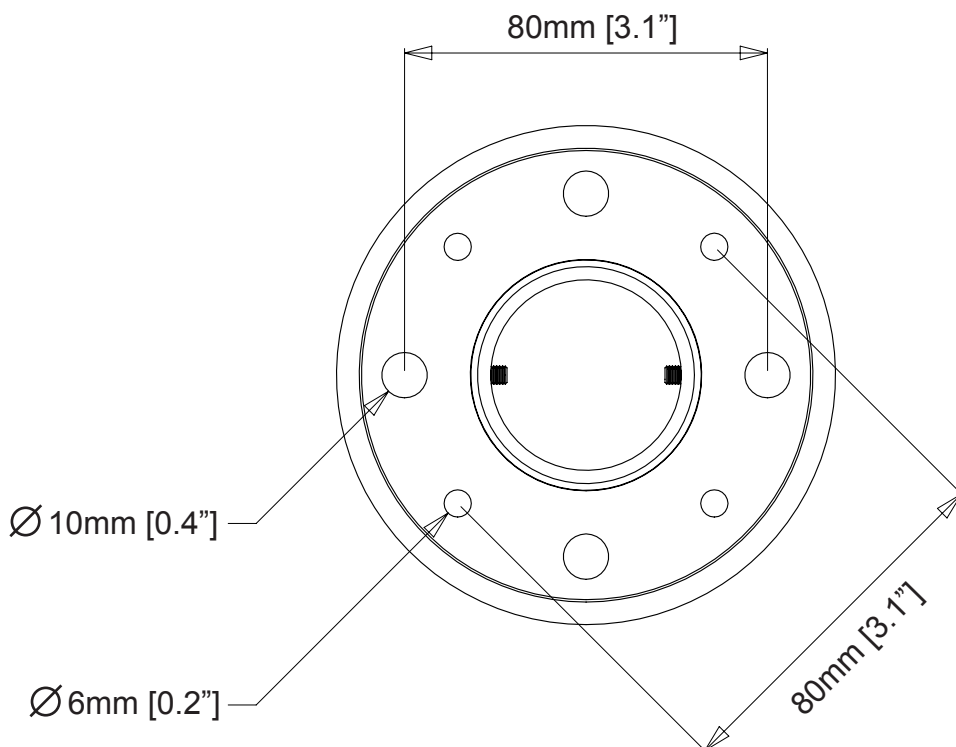

PM - Projector Mount System



Wall Mount

Wall option - The arm sits 300mm [11.8"] from the wall to the centre of the locking collar, bespoke sizes can be manufactured. Up to 360 degrees rotation available as long as the projector's movement isn't restricted by the wall.

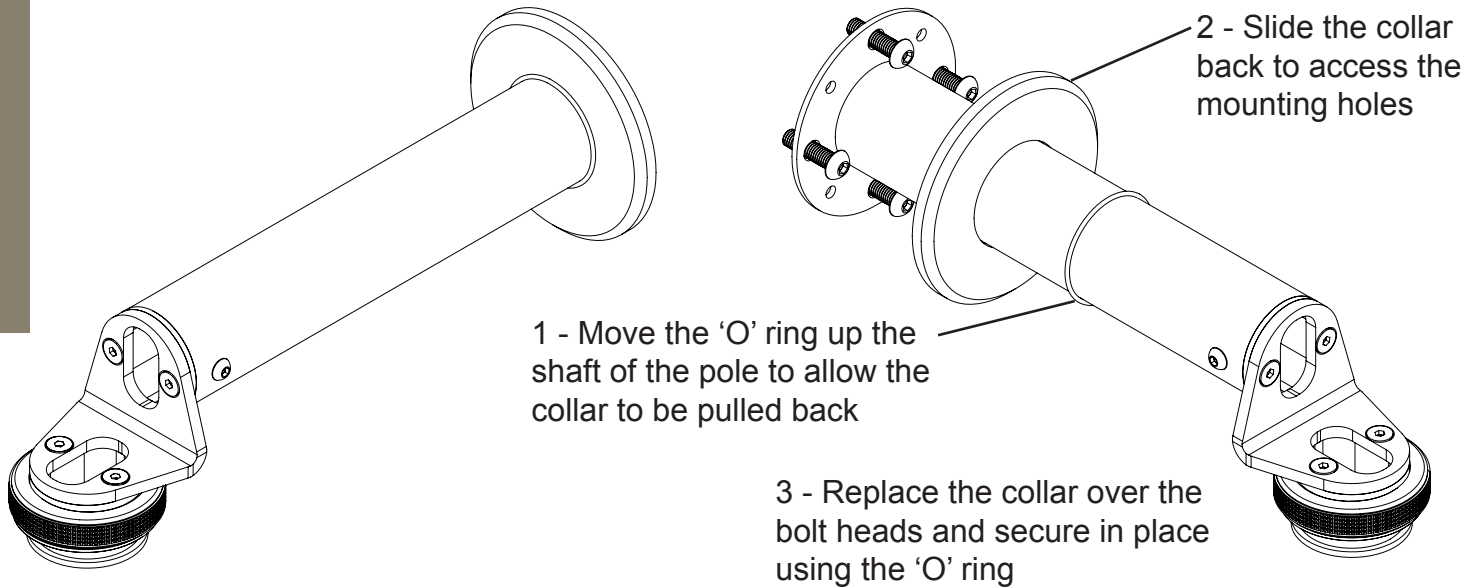

It is the installer's responsibility to make sure the mechanism is installed safely and securely

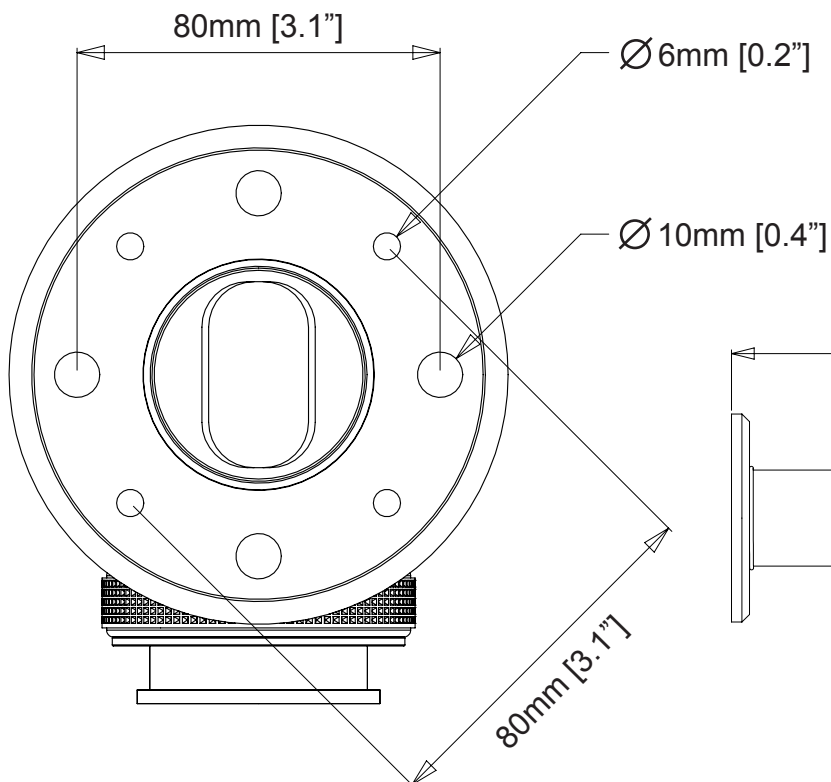

Important Mounting Dimensions
(Note - Drawings are not to Scale)

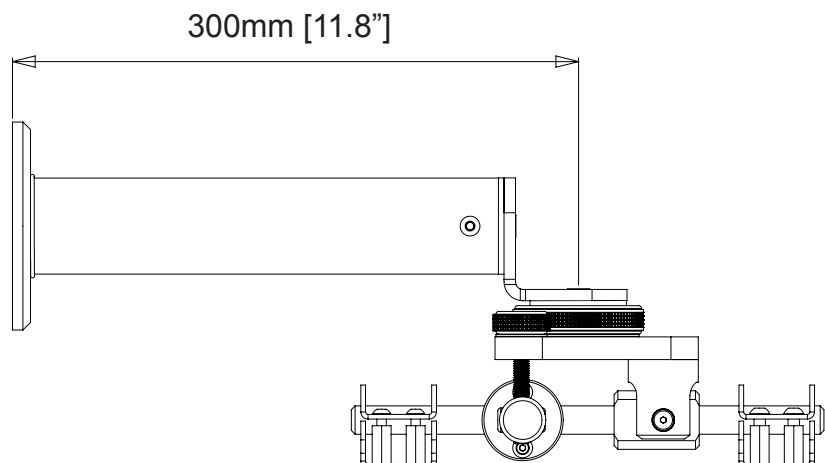

PM - Projector Mount System



Mount the Projector

Arrange the cross bars so they line up with the fixing holes on the projector. Use the fixings provided to secure into place.

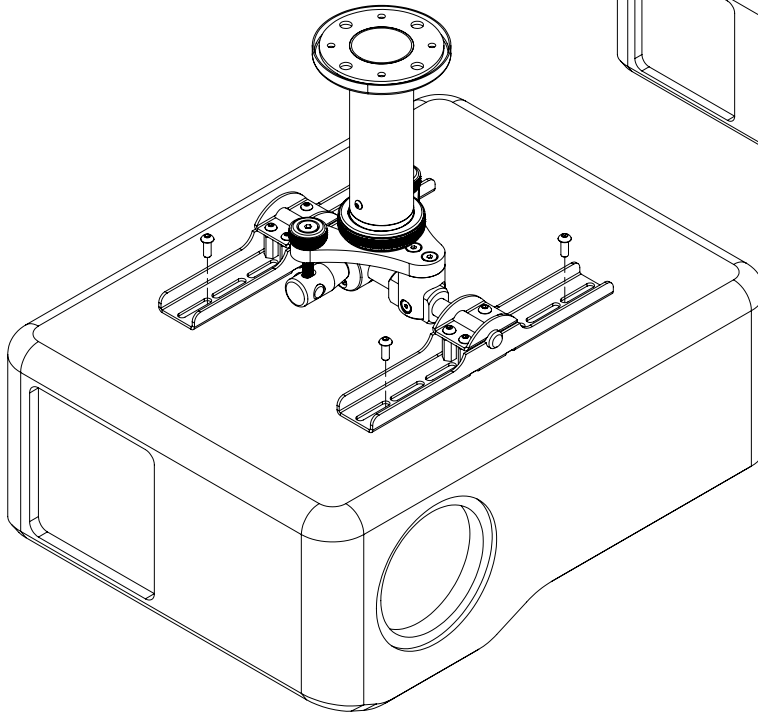
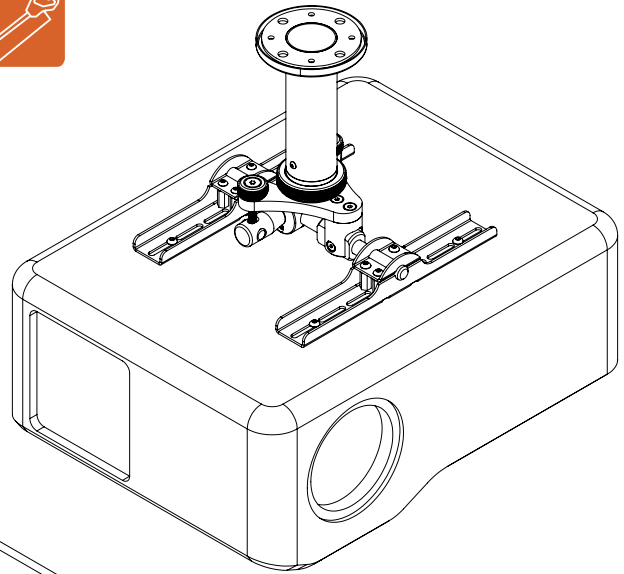

Make sure that the projector is fixed securely and safe

If you can't get the mounting plate to fit the projector, a custom adapter plate can be designed and manufactured.

Other mounting possibilities

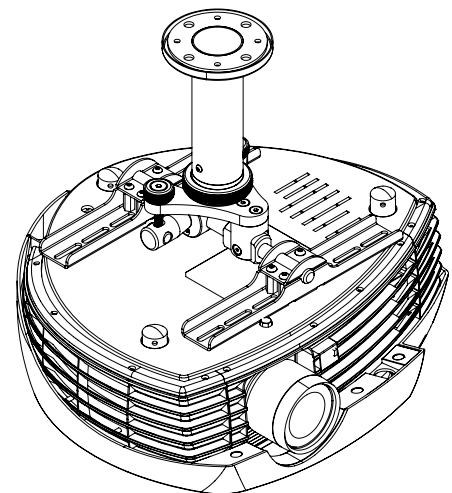
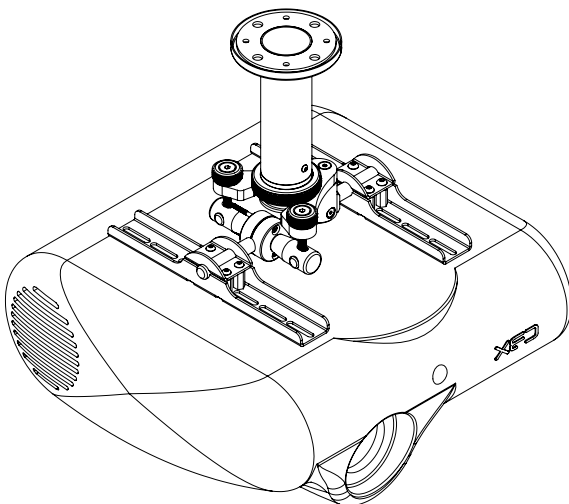

PM - Projector Mount System



Connecting the PM system to the locking collar

Hook the main body on to the bottom of the ceiling mount part of the system.
Tighten the large nut down to secure the main body in place.

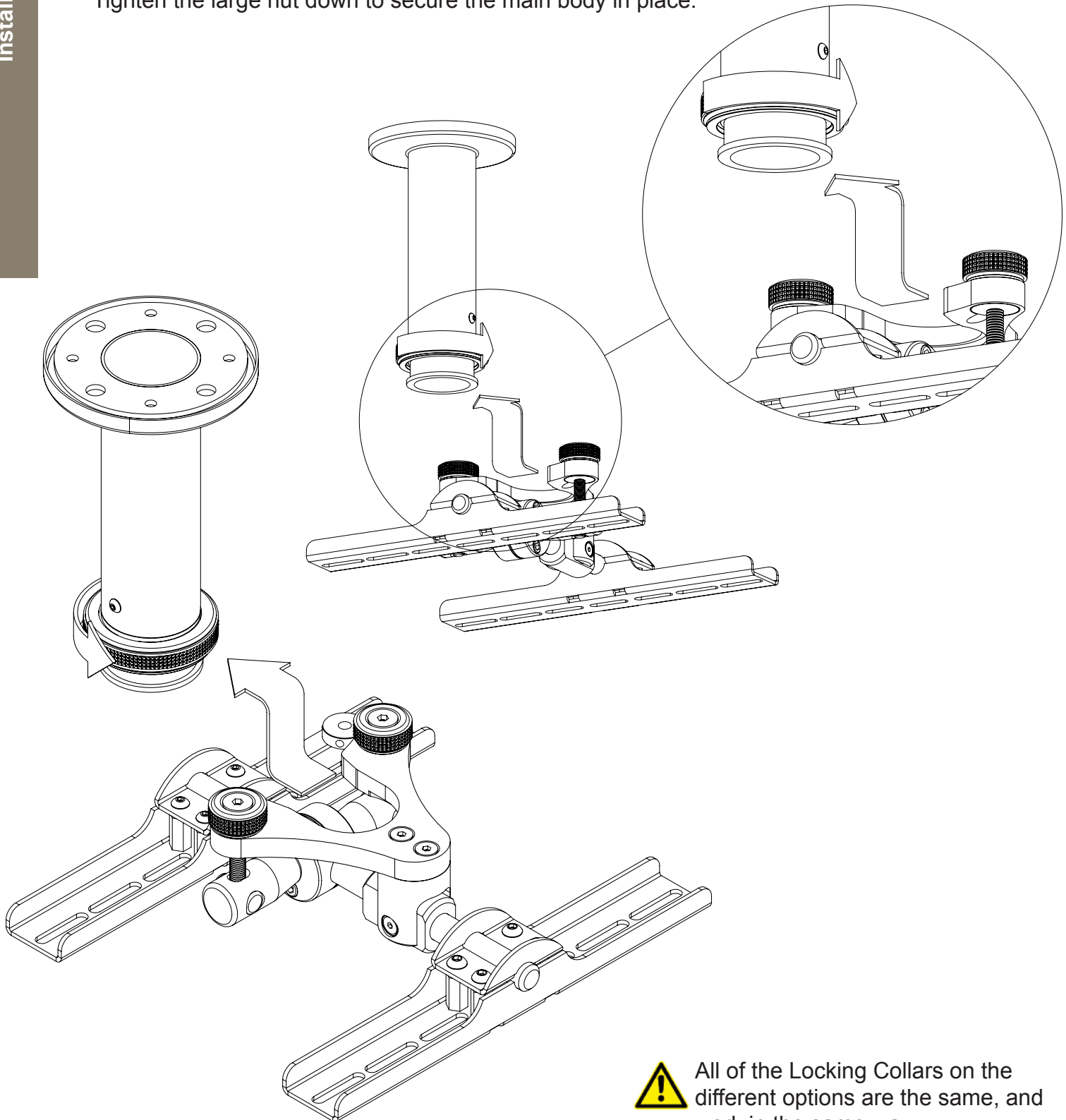

All of the Locking Collars on the different options are the same, and work in the same way.

PM - Projector Mount System



Projection Adjustment

The position of the projector can be pitched and/or tilted by adjusting 2 knurled knobs on top of the main body.

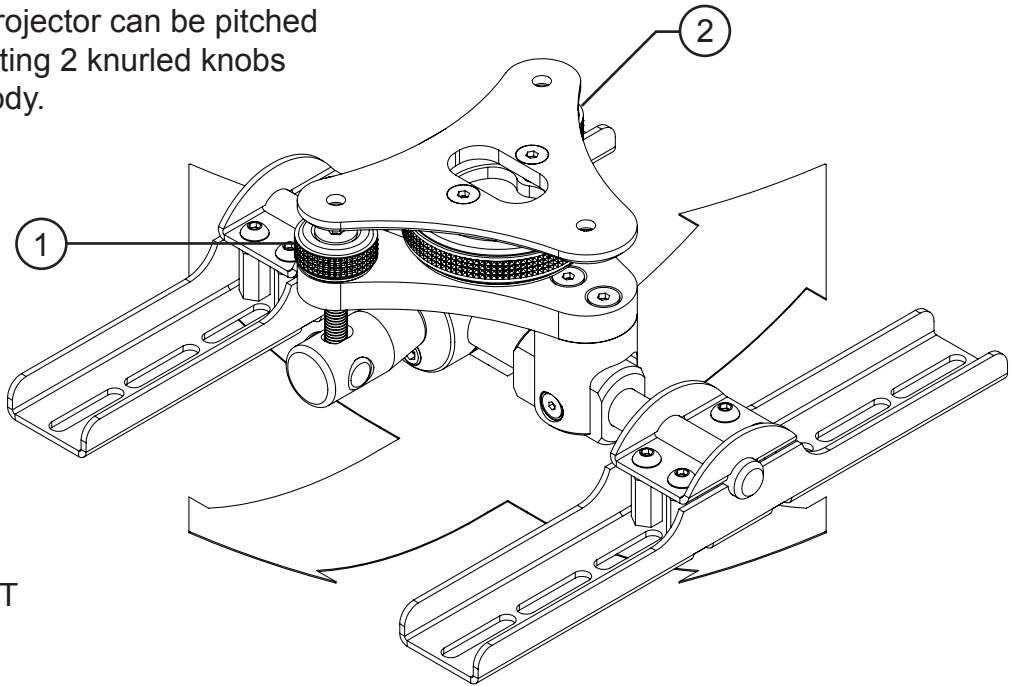

4 WAY MOVEMENT

Rotate both knobs in SAME DIRECTION to adjust TILT
Rotate both knobs in OPPOSITE DIRECTION to adjust PITCH

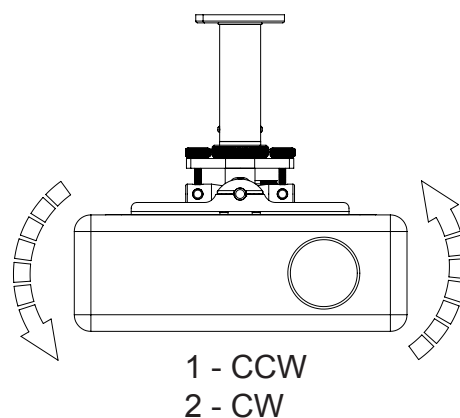
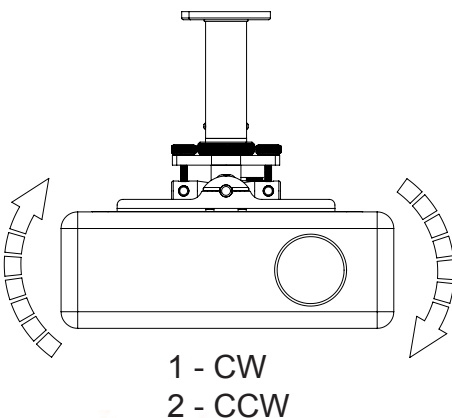
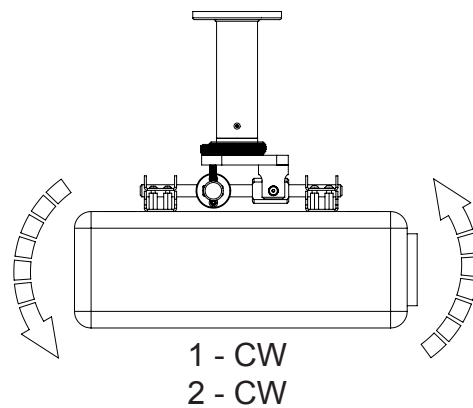
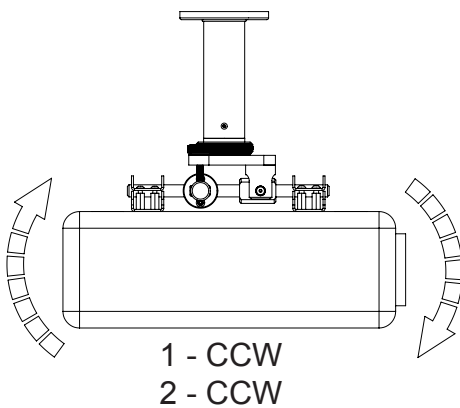

PM - Projector Mount System



A general technical overview of the PM Projector Mount System.

PM1 / PM2										
Mount Type	Flush Mount			Pole Mount				Telescopic Pole Mount		Wall Mount
Sizes (B - Bespoke)	N/A			250	500	750	B	400T	700T	300
Product Dimensions (W,D,H) - mm [""] Main Body	107.5x133x100mm [4.2x5.2x3.9"]			107.5x133x100mm [4.2x5.2x3.9"]				107.5x133x100mm [4.2x5.2x3.9"]		107.5x133x100mm [4.2x5.2x3.9"]
Weight Kg [lb]	1Kg [2.2lb]			1.2Kg [2.6lb]	2Kg [4.4lb]	2.5Kg [5.5lb]	N/A	2Kg [4.4lb]	3Kg [6.6lb]	1.5Kg [3.3lb]
Maximum Projector Weight Kg [lb]	45Kg [99.2lb]			45Kg [99.2lb]				45Kg [99.2lb]		45Kg [99.2lb]
Standard Colour	Clear or black anodised aluminium			Clear or black anodised aluminium				Clear or black anodised aluminium		Clear or black anodised aluminium
Depth from Ceiling mm [""]	100mm [3.9"]			250mm [9.8"]	500mm [19.7"]	750mm [29.5"]	N/A	400-700mm [15.7-27.6"]	700-1300mm [27.6-51.1"]	300mm [11.8"]
Control	Manual			Manual				Manual		Manual
Shipping Details										
Dimensions W,D,H - mm [""]	400x300x200mm [15.7x11.8x7.9"]			400x300x200 (Pole Seperate) [15.7x11.8x7.9"]				400x300x200 (Pole Seperate) [15.7x11.8x7.9"]		400x300x200 (Pole Seperate) [15.7x11.8x7.9"]
Weight Kg [lb]	2Kg [4.4lb]			2.2Kg [4.9lb]	3Kg [6.6lb]	3.5Kg [7.7lb]	N/A	3Kg [6.6lb]	4Kg [8.8lb]	2.5Kg [5.5lb]

PM - Projector Mount System



Notes...



Future Automation

Unit 2 Kimpton Enterprise Park
Claggy Road
Kimpton
Hertfordshire
SG4 8HP
United Kingdom

Tel: +44 (0) 1438 833 577

Fax: +44 (0) 1438 833 565

Email: info@futureautomation.co.uk

www.futureautomation.co.uk