



Owner's Manual

Insight P7m-LCR

Insight P9m-LCR

LCR Planar Magnetic Soundbar Loudspeaker

Table of Contents

Introduction | 3

Overview | 4

Unpacking and Installing the Insight P7m/P9m | 5

Mounting Options | 6

Mounting the P7m/P9m on the Wall | 6

Mounting the P7m/P9m To a TV Vesa Mount | 8

Care & Maintenance | 21

North American Warranty | 21

Obtaining Service | 22

Specifications | 23

Dimensions | 24

DOCUMENT CONVENTIONS

This document contains general safety, installation, and operation instructions for the Wisdom Audio Insight P7M/P9Mm Loudspeaker. It is important to read this document before attempting to use this product. Pay particular attention to:

WARNING: Calls attention to a procedure, practice, condition or the like that, if not correctly performed or adhered to, could result in injury or death.

CAUTION: Calls attention to a procedure, practice, condition or the like that, if not correctly performed or adhered to, could result in damage to or destruction of part of or the entire product.

Note: Calls attention to information that aids in the installation or operation of the product.

Introduction

Congratulations on purchasing your Wisdom Audio system. It incorporates many design features engineered to give you decades of pleasure and performance. Many of these design choices are uncommon among loudspeaker manufacturers and bear some explanation. See the following section entitled “Overview” for more information.

The Insight Series P7m-LCR and P9m-LCR Soundbars are specifically designed to avoid the compromises inherent in other conventional soundbar “custom length” designs, so you will not have to give up any sound quality just to have it match the width of your TV.

The P7m-LCR Soundbar is available in custom lengths from a minimum width of 56.4” (1433mm) and a maximum width of 70.4” (1788mm). The P7m-LCR contains (3) Spherical PMDs for the high frequencies playing down to an amazing 900 Hz, and (4) 4.5” Woofers to do the low-frequency heavy lifting.

The P9m-LCR is available in custom lengths from a minimum of 65.42” (1661mm) and a maximum of 90.8” (2306mm). It contains (3) Spherical PMDs for the high frequencies playing down to an amazing 900 Hz and (6) 4.5” Woofers to do the low-frequency heavy lifting.

Your **Insight P7m/P9m series** loudspeaker are specifically designed to avoid the compromises inherent in conventional speaker designs. Each P7m or P9m Series speakers is customized to fit the width of your specific TV. Before ordering, contact Wisdom Audio Sales for specific details on sizes and customization. Info@wisdomaudio.com

Overview

P9m-LCR Front View (Grille On)



P9m-LCR Front View (Grille Off) – Do Not Remove the Grille! The grille is an integral part of the design; moreover, the planar magnetic film should never be touched, as it is tensioned precisely at the factory. The grille plays an important protective role as well as an aesthetic one.



P7m-LCR Front View (Grille On)



P7m-LCR Front View (Grille Off) – Do Not Remove the Grille! The grille is an integral part of the design; moreover, the planar magnetic film should never be touched, as it is tensioned precisely at the factory. The grille plays an important protective role as well as an aesthetic one.



P7m-LCR and P9m-LCR Rear View Shown with Wall Mount Bracket



Removable Speaker
Wire Input Terminal

Unpacking and Installing the P7m/P9m

The **Wisdom Audio Insight P7m/P9m** speaker is a substantial piece of equipment. Please exercise caution when unpacking your P7M/P9Mm to ensure that you do not strain yourself from its (perhaps unexpected) weight.

CAUTION: Do not attempt to lift your P7m/P9m while bending or twisting from the waist. Use your legs for lifting, not your back. Always stand as straight as possible and keep the P7M/P9Mm close to your body to reduce strain on your back.

With one person at each end, carefully lift the speaker out of the box and lay it on a soft surface (carpet or similar).

After unpacking your P7m/P9m, keep all packing materials for future transport.

Making the P7m/P9m Connections

As with any system, you should make changes to the connections only when the power is turned off to avoid any chance of inadvertently causing a problem (such as a short-circuit).

Three sets of speaker wires are required for each Insight P7m/P9m loudspeaker, one for each channel of Left / Center / Right.

The connections are made on a removable 6-way connector (commonly called a “Phoenix” connector). These will accept up to 12AWG (4.0mm²) wire. This removable terminal has small retainer tabs that require 10 Ft-lbs (13.5Nm) to remove. It may be necessary to use a small tool to help remove the terminal, but once inserted it should not come out easily.

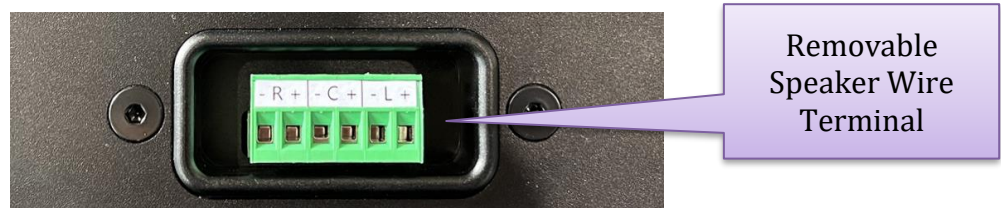

Connect the outputs of your amplifier to the appropriate sections, taking care to get both the channel assignments and the polarity correct. Connect the positive (+) terminals on the amplifier to the positive (+) terminals on the loudspeaker; likewise, connect the negative (-) terminals on the amplifier and the speaker, respectively.

Mounting Options for the P7m/P9m Series

There are 2 mounting options for the P7m/P9m Series. You must select one of these two options when ordering the loudspeaker.

- **WMA-IS** - Insight Soundbar Wall Mount (any size) PN# 942100
- **VESA-IS** - Insight Soundbar Vesa TV Mount (any size) PN# 942200

Mounting the P7m/P9m on the Wall Using the WMA-IS

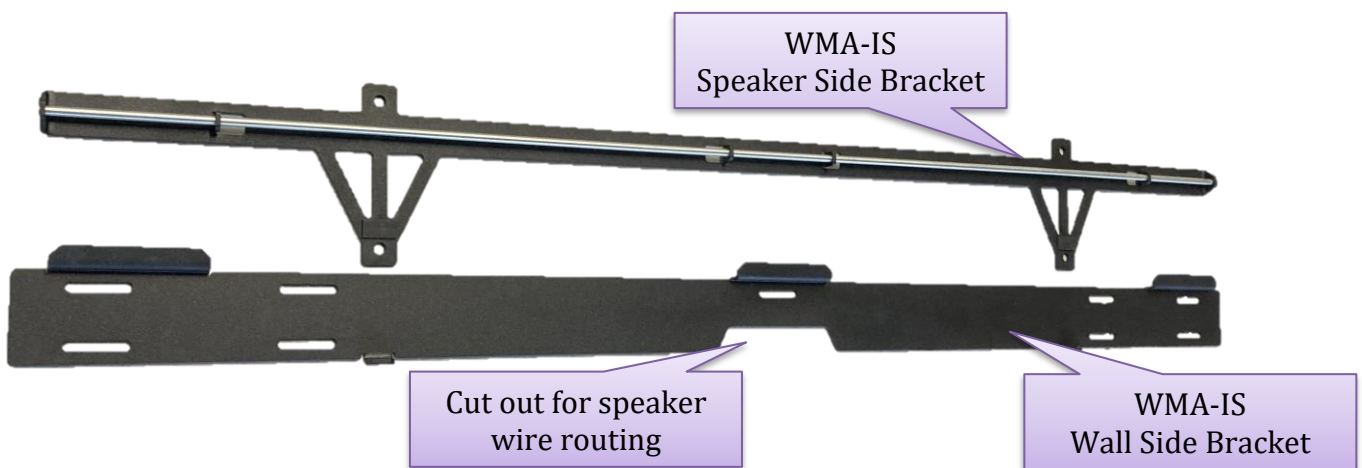

The Mounting bracket has slots that accommodate up to #10 (M5) Screws. *It is recommended to place a screw into every open mounting hole for maximum safety. Failure to use the proper screws and wall attachment hardware may result in damage or injury.*

Slots are arranged for 16" (406mm) On-center and 24" (610mm) On-center stud locations.

If you are not able to mount directly into a stud, use the appropriate masonry or dry-wall toggle bolts that are rated for at least 25 lbs (10kg) each, and use *at least* 4 minimum, and 5 recommended (1 pair per side plus the center).

- For a "zero clearance" installation, with the TV flush to the Soundbar, mount the Soundbar first and the TV second to allow the TV to mount directly above the Soundbar.
- If mounting the Soundbar *after* the TV, you must allow for 0.45" (11.5mm) of clearance between the TV and the Soundbar for the wall mount installation.

Please note that this guide assumes the wall surface is flat. If not, shims must be applied to the rear of the mounting bracket so that the mounting bracket is uniformly secured to the wall and flat (not distorted). The mounting steps are as follows:

1. Locate the area with the three sets speaker cables coming out of the wall.
2. Remove the screw down terminal from the speaker and pre-wire the connector.
3. The wall bracket should have the tabs facing up. The slot in the center is also the center of the speaker and should be used to align the soundbar centered on the wall.
4. Using a bubble level to ensure that the mounting bracket is plumb, mark screw holes for screws or toggle bolts, using the bracket itself as your template. You can use any pair of slots for mounting, plus the center in each end clip. Use both an upper and a lower screw to ensure the bracket is stable.
5. Install screws suitable for the specific wall material (e.g., sheetrock, brick, concrete, etc.) in all the remaining holes in the mounting bracket to ensure secure attachment to wall and avoid any resonance from mounting bracket. Snug down the center screw as well.
6. Attach the Speaker Side Bracket to the rear of the soundbar. The 4 mounting screws in the rear of the case will line up with the mounting holes in the bracket. Make sure to tighten the screws.
7. Using assistance, while holding the speaker away from the wall, connect the speaker terminal block until it clicks into place.
8. Slide the speaker from the top down onto the matching cleat. The bracket will center the speaker once installed.



If you need to remove the speaker from the bracket for any reason, lift out from the bottom and then up. Be sure to remove the speaker wire terminal before pulling away from the wall.

Important! Do not use the P7m/P9m as a shelf! While its mounting system is quite rugged, it is designed to securely support the weight of the speaker itself. Do not place additional objects on it, and do not climb on it.

Mounting the P7m/P9m on the Wall Using the VESA-IS

The Vesa can be used with standard Vesa mount patterns on most TVs. The Vesa mount allows the soundbar to be mounted to the TV for use with swivel and articulating mounts. *Ensure that your TV can handle the weight of the soundbar before attempting to attach it. The soundbar is not to be used as a handle for moving the TV. Failure to use the proper screws and wall attachment hardware may result in damage or injury.*

Tools Needed:

- 10mm Open end wrench
- 6mm (M6) Hex Key
- #2 Phillips head screwdriver

Standard Vesa Mount Patterns include:

- 400 mm x 400 mm (400 mm = 15.7 inches)
- 600 mm x 400 mm (600 mm = 23.6 inches)
- 800 mm x 400 mm (800 mm = 31.5 inches)

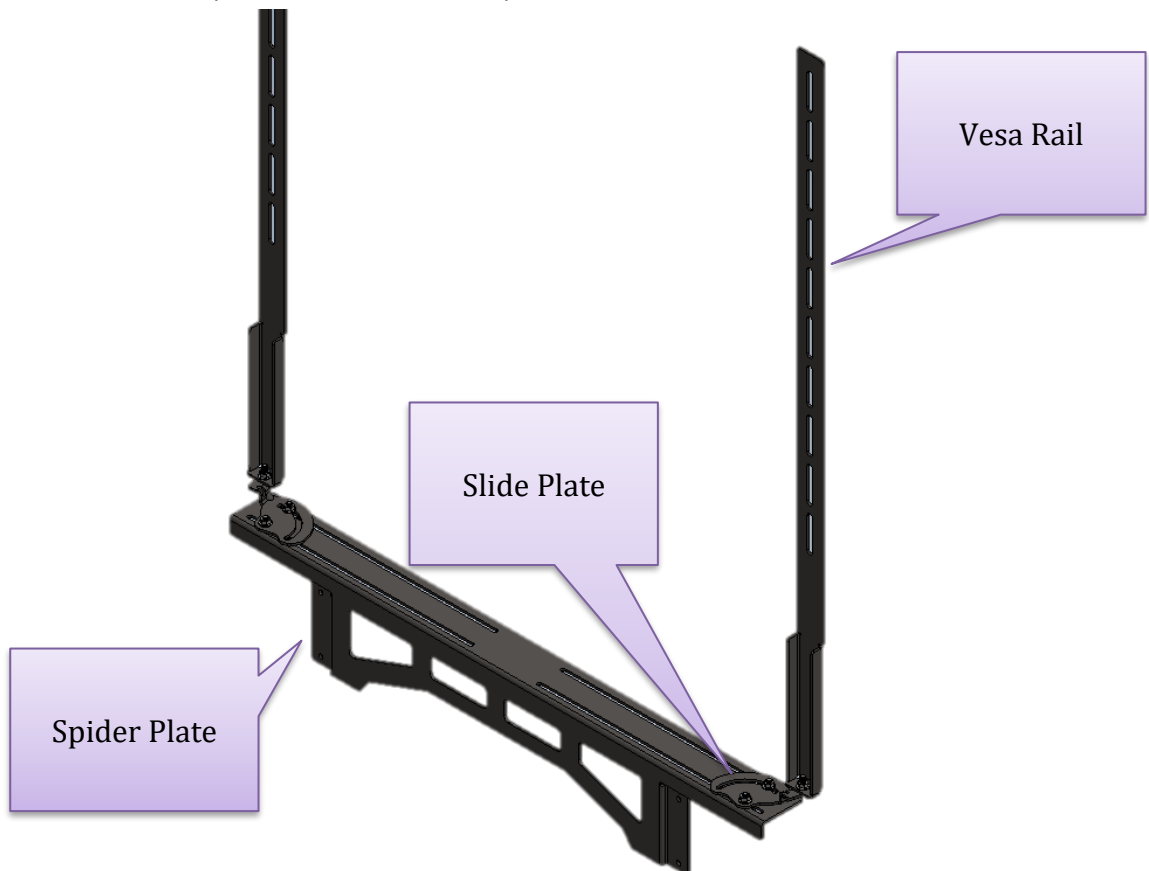

1. Prepare the wiring behind the TV:

- a. Locate the area with the three sets speaker cables coming out of the wall.
- b. Remove the screw down terminal from the speaker and pre-wire the connector. Run the wire along the articulating mount with the other wires from the TV as needed.

2. Prepare the TV:

- a. If the TV mount has already been attached to the TV, remove it temporarily.
- b. If the TV mount has not been attached to the TV, find the TV mount hardware you will use. The screws are usually M6 or M8 size Phillips head.
- c. Make sure you follow the TV mount instructions correctly and use all the proper hardware. Failure to do so could result in damage to the TV or injury to the user.
- d. Place the TV face down on a suitable protective work surface where you can test fit the speaker mount before placing on the wall, such as a moving blanket on the floor or similar.
- e. If the TV has an IR sensor or uneven surface on the bottom, use the included black foam tape to take up the space. The Soundbar will mount up against this to remove any visible space and make for a fully blacked out installation.



3. Assemble the 2 Slide Plates to the Spider Plate using the included 10mm nuts. They are mirror images of each other. **At this time, they should only be finger tight. They will need to slide and pivot for final adjustment.**

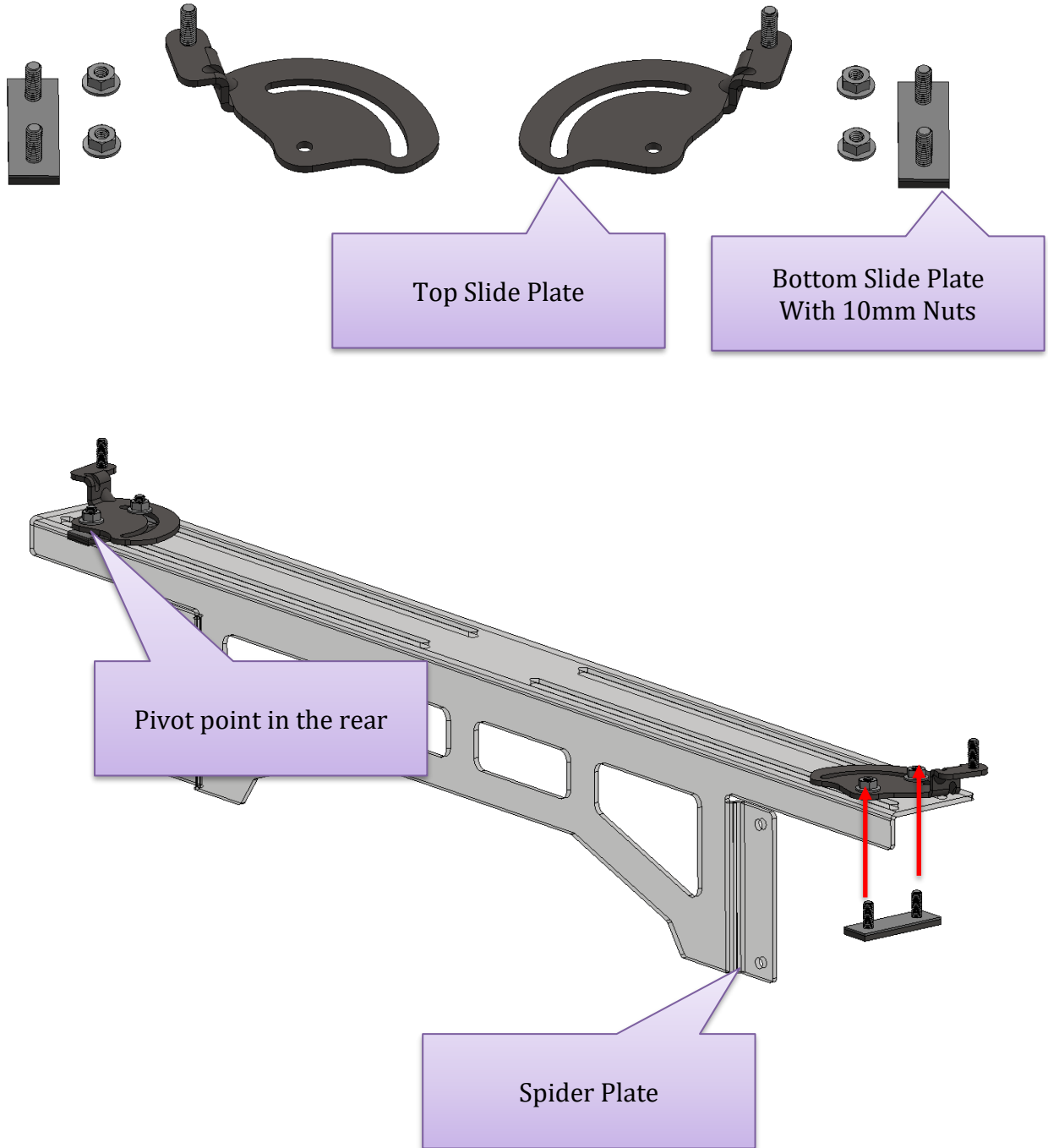

4. Attach the completed bracket to the rear of the soundbar:
 - a. Place the soundbar face down on a protective blanket or other work surface
 - b. Remove the four (4) Phillips screws in the rear case of the soundbar
 - c. Attach the rear panel bracket on the soundbar using the four screws
 - d. Ensure they are tightened down.



5. With the TV on the floor or other protective work surface, position the soundbar underneath the TV and centered.



6. Prepare the Vesa Rails

- a. There are 2 lengths of Vesa Rails. Depending on the size of your TV, pick the correct size.
 - i. For most 65" TV the short rail will be correct.
 - ii. For most 75" and larger, the long rail will be correct.
- b. Loosen the set screw and the retainer nut but **do not remove the screws**
- c. Move the height adjustment to the lowest position and finger tight only.

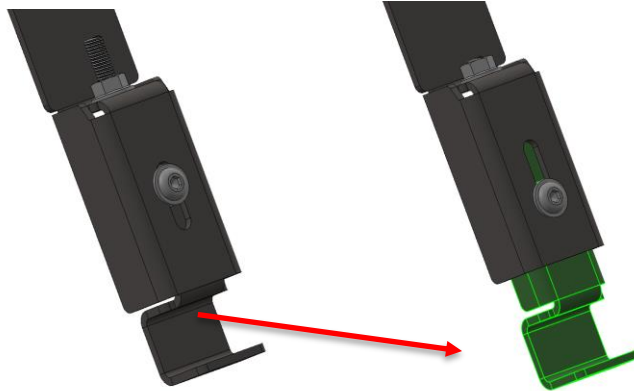

7. Place the Vesa Rails onto the TV and adjust the rails and slide plates.

- a. Place the rails onto the slide plates
- b. Move the slide plates horizontally so they are close to the correct position on the rear of the TV, lined up with the TV mounting holes.
- c. Rotating the slide plates will allow the correct front face alignment.





- d. The Rails should line up with the TV mounting locations. The rails can be moved slightly up or down as needed. Final Height adjustment will be done at the end and any gap will be eliminated.



- e. Place the TV Mount over the Vesa Rails and scw the TV mount and Vesa Rails to the TV. Tighten all TV mount screws to lock the rails into place.

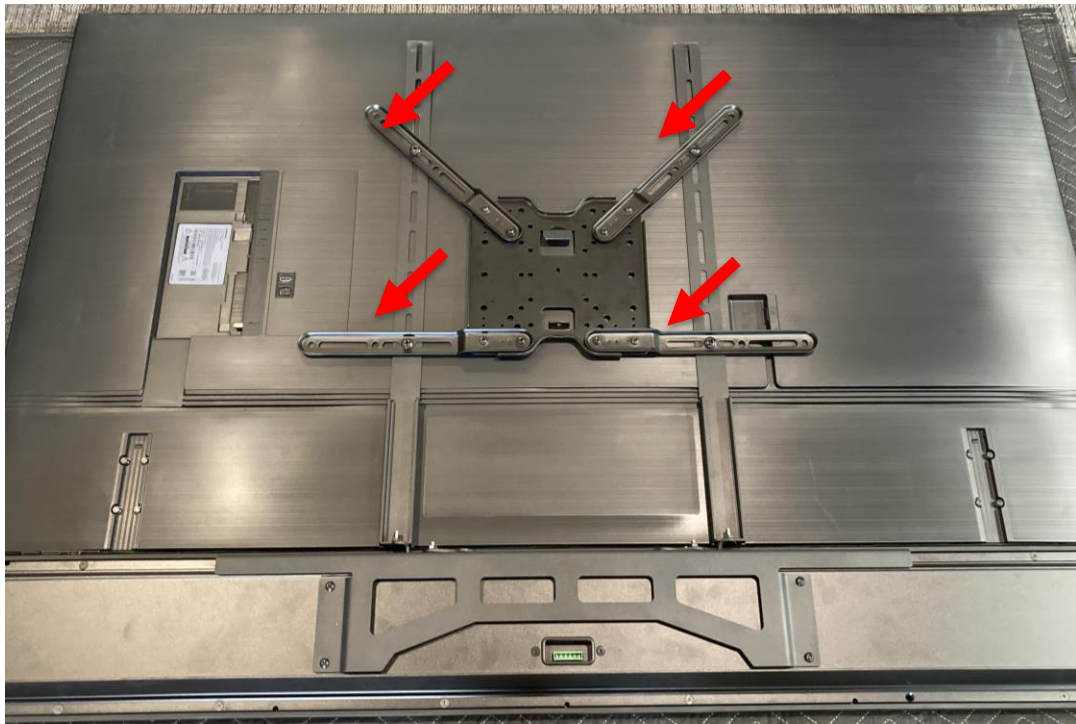
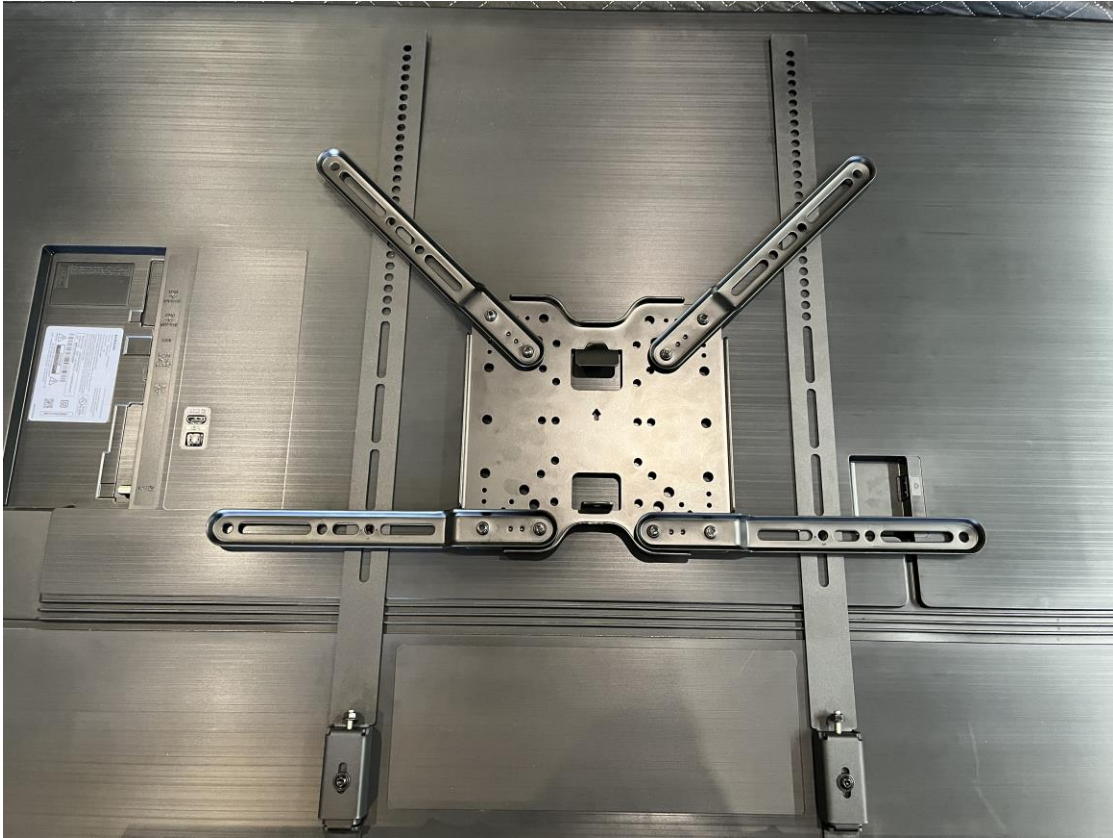

- f. Tighten the Slide Plates using a 10mm wrench and the two (2) bolts. This will lock the speaker to the TV aligned to the front of the TV and centered on the Vesa mounting pattern.



8. Mount the Soundbar to the TV Vesa Rails

- a. Mount the TV to the wall mount **WITHOUT** the Soundbar attached

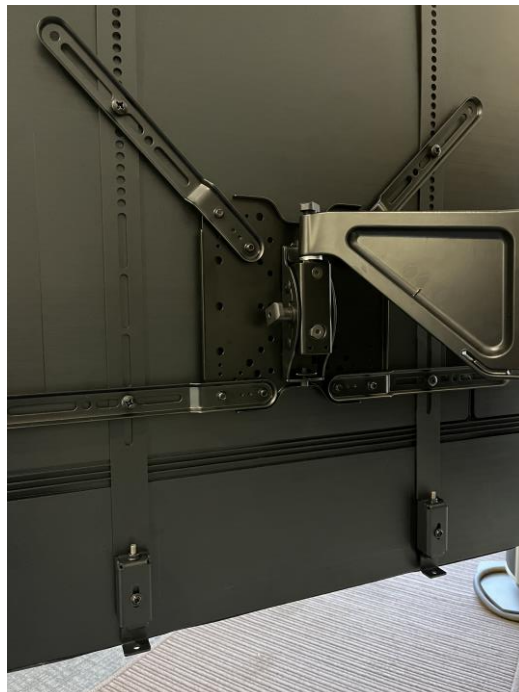

b. Using two (2) people, place the soundbar into position. It may be helpful to have a third person to help line up and hold the speaker.



- c. Thread on the 10mm bolt on each side BEFORE letting go of the speaker and tighten with the 10mm wrench.



9. Adjust the height to create a tight fit to the TV (against the foam tape applied in the second step).
 - a. Tightening the top nut will raise the soundbar tighter to the TV
 - b. Loosening the top nut will lower the soundbar
 - c. DO NOT OVERTIGHTEN. Just enough to contact the foam tape and create a light tight fit. If you overtighten the soundbar will begin to tilt down and not be flush with the front of the TV.
 - d. Tighten each side a small amount and work back and forth and raise the soundbar evenly.

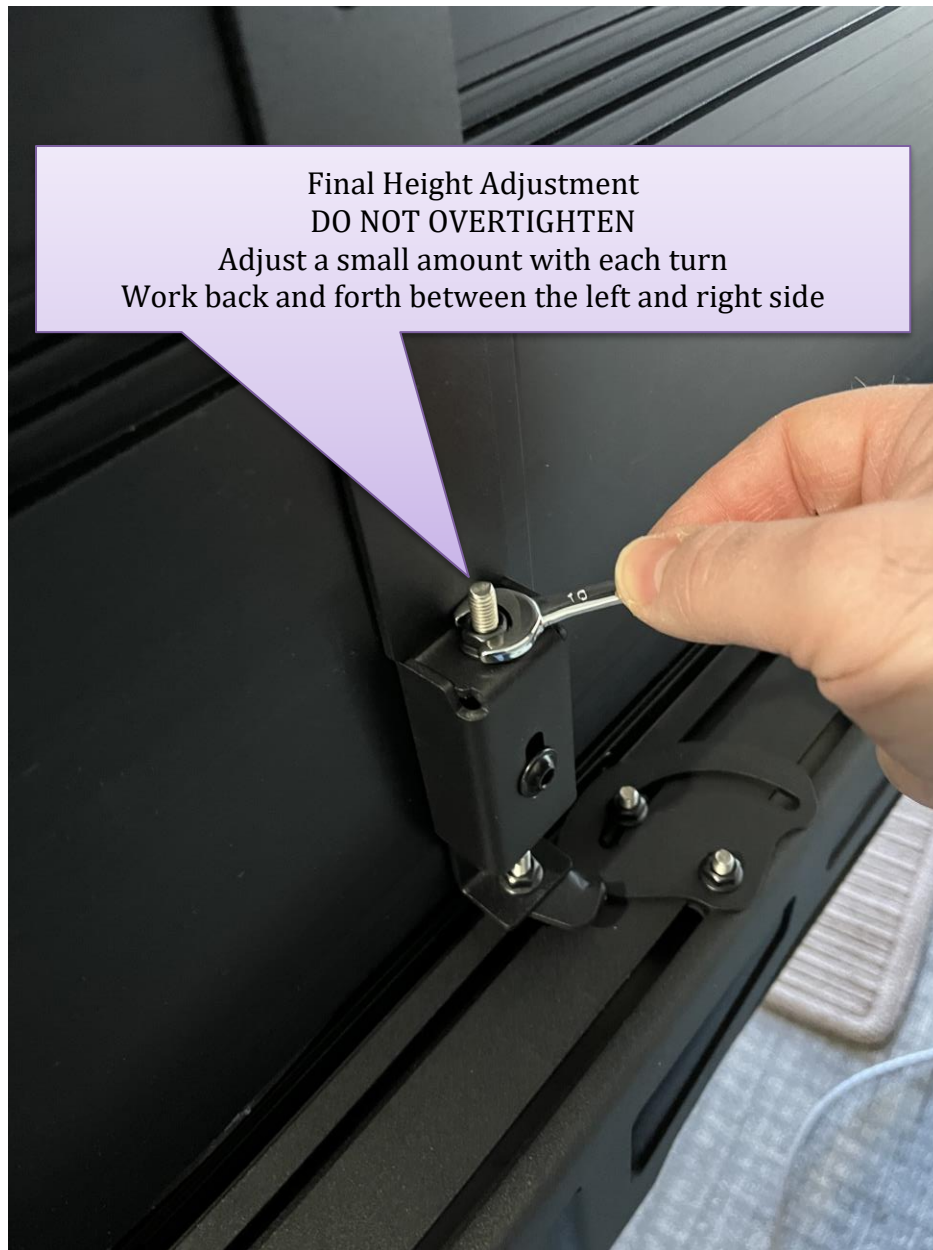

- e. Tighten the lock screw once the correct height is obtained.



10. Check all connections and attach wiring

- a. Check all bolts and screws that they are tight and make any adjustments to the soundbar position before finalizing the wiring.
- b. Follow the manufacturer's instructions for wire management and attach the speaker terminal block to the rear of the speaker.

Care & Maintenance

To remove dust from the front of your P7m/P9m, use a feather duster or a lint-free soft cloth.

Never attempt to clean the drivers themselves.

Caution!

Do not touch the surface of the planar magnetic drivers, under any circumstances. The thin film has been carefully pre-tensioned at the factory; any subsequent contact can only damage it.

North American Warranty

Standard Warranty

When purchased from and installed by an authorized Wisdom Audio dealer, Wisdom Audio loudspeakers are warranted to be free from defects in material and workmanship under normal use for a period of 10 years from the original date of purchase.

Furthermore, the transducers (“drivers”) in your Wisdom Audio speakers are warranted to be free from defects in material and workmanship under normal use for a period of 10 years from the original date of purchase.

Harsh Conditions Use

Wisdom Audio loudspeakers are designed for installation and operation in environmentally controlled conditions, such as are found in normal residential environments. When used in harsh conditions such as outdoors or in marine applications, the warranty is three years from the original date of purchase.

During the warranty period, any Wisdom Audio products exhibiting defects in materials and/or workmanship will be repaired or replaced, at our option, without charge for either parts or labor, at our factory. The warranty will not apply to any Wisdom Audio products that has been misused, abused, altered, or installed and calibrated by anyone other than an authorized Wisdom Audio dealer.

Any Wisdom Audio product not performing satisfactorily may be returned to the factory for evaluation. Return authorization must first be obtained by either calling or writing the factory prior to shipping the

component. The factory will pay for return shipping charges only if the component is found to be defective as mentioned above. There are other stipulations that may apply to shipping charges.

There is no other express warranty on Wisdom Audio products. Neither this warranty nor any other warranty, express or implied, including any implied warranties of merchantability or fitness, shall extend beyond the warranty period. No responsibility is assumed for any incidental or consequential damages. Some states do not allow limitations on how long an implied warranty lasts and other states do not allow the exclusion or limitation of incidental or consequential damages, so the above limitation or exclusion may not apply to you.

This warranty gives you specific legal rights, and you may also have other rights, which vary from state to state. This warranty is applicable in the United States and Canada only. Outside of the U.S. and Canada, please contact your local, authorized Wisdom Audio distributor for warranty and service information.

Obtaining Service

We take great pride in our dealers. Experience, dedication, and integrity make these professionals ideally suited to assist with our customers' service needs.

If your Wisdom Audio loudspeaker must be serviced, please contact your dealer. Your dealer will then decide whether the problem can be remedied locally, or whether to contact Wisdom Audio for further service information or parts, or to obtain a Return Authorization. The Wisdom Audio Service Department works closely with your dealer to solve your service needs expediently.

IMPORTANT: Return authorization must be obtained from Wisdom Audio's Service Department BEFORE a unit is shipped for service.

It is extremely important that information about a problem be explicit and complete. A specific, comprehensive description of the problem helps your dealer and the Wisdom Audio Service Department locate and repair the difficulty as quickly as possible.

A copy of the original bill of sale will serve to verify warranty status. Please include it with the unit when it is brought in for warranty service.

WARNING: All returned units must be packaged in their original packaging, and the proper return authorization numbers must be marked on the outer carton for identification. Shipping the unit in improper packaging may void the warranty, as Wisdom Audio cannot be responsible for the resulting shipping damage.

Your dealer can order a new set of shipping materials for you if you need to ship your loudspeaker and no longer have the original materials. There will be a charge for this service. We strongly recommend saving all packing materials in case you need to ship your unit someday.

If the packaging to protect the unit is, in our opinion or that of our dealer, inadequate to protect the unit, we reserve the right to repackage it for return shipment at the owner's expense. Neither Wisdom Audio nor your dealer can be responsible for shipping damage due to improper (that is, non-original) packaging.

Specifications

All specifications are subject to change at any time to improve the product.

P7m-LCR

Dual Woofer + Spherical PMD Center "MTM"; Single Woofer + Spherical PMD L+R "MT"

Designed for 65" to 77" nominal diagonal TV sizes

- absolute minimum width is 56.4" (1433mm)
- absolute maximum width is 70.4" (1788mm)

Spec/Performance

- Sensitivity:
 - Center: 86dB, 2.83V@1m
 - Left and Right: 80dB, 2.83V@1m
- Frequency Response (+/-3dB): 90Hz-20kHz
- Low Frequency Bandwidth (-10dB): 50Hz
- Coverage Angle Horizontal x Vertical (-6dB):
 - Center: 100 x 110 degrees
 - Left and Right: 110 x 110 degrees
- Recommended Minimum Amplifier: 75 Watts
- Maximum Power Handling: 200 Watts
- Impedance:
 - Center: 4 ohms
 - Left and Right : 8 ohms
- Net Weight (maximum weight with largest supported TV) = 31.5lbs (14kg)

P9m-LCR

Dual Woofer + Spherical PMD LCR "MTM x3"

Designed for 75" to 100" nominal diagonal TV sizes

- absolute minimum width is 65.42" (1661mm)
- absolute maximum width is 90.8" (2306mm)

Spec/Performance

- Sensitivity: 86dB, 2.83V@1m
- Frequency Response (+/-3dB): 90Hz-20kHz
- Low Frequency Bandwidth (-10dB): 54Hz
- Coverage Angle Horizontal x Vertical (-6dB): Left / Center / Right: 100 x 110 degrees
- Recommended Minimum Amplifier: 75 Watts
- Maximum Power Handling: 200 Watts
- Impedance: 4 ohms
- Net Weight (maximum weight with largest supported TV) = 40lbs (18kg)

P7m/P9m Dimensions

Common Dimensions:

Depth with Wall Mount: 3.85" (97.8mm)

Depth with TV Vesa Mount: 3.625" (92.1mm)

Height: 7.25" (184mm)

Note: If mounting the Soundbar after the TV with the Wall Mount, allow for 0.45" (11.5mm) of clearance above the Soundbar for the wall mount installation.

P7m

- absolute minimum width is 56.4" (1433mm)
- absolute maximum width is 70.4" (1788mm)

P9m

- absolute minimum width is 65.42" (1661mm)
- absolute maximum width is 90.8" (2306mm)

For more information, see your Wisdom Audio dealer or contact Wisdom Audio:



W I S D O M[®]

WISDOM and the stylized W are registered trademarks of Wisdom Audio.

Wisdom Audio
1572 College Parkway, Suite 164
Carson City, Nevada 89706 USA
TEL (775) 887-8850
FAX (775) 887-8820
wisdomaudio.com